

RETRACT AND BRAKE AIR SYSTEMS SCHEMATIC DRAWING FOR PST JETS REACTION ARF WITH THE PRO-LINKS RETRACTS DELUXE COMBO

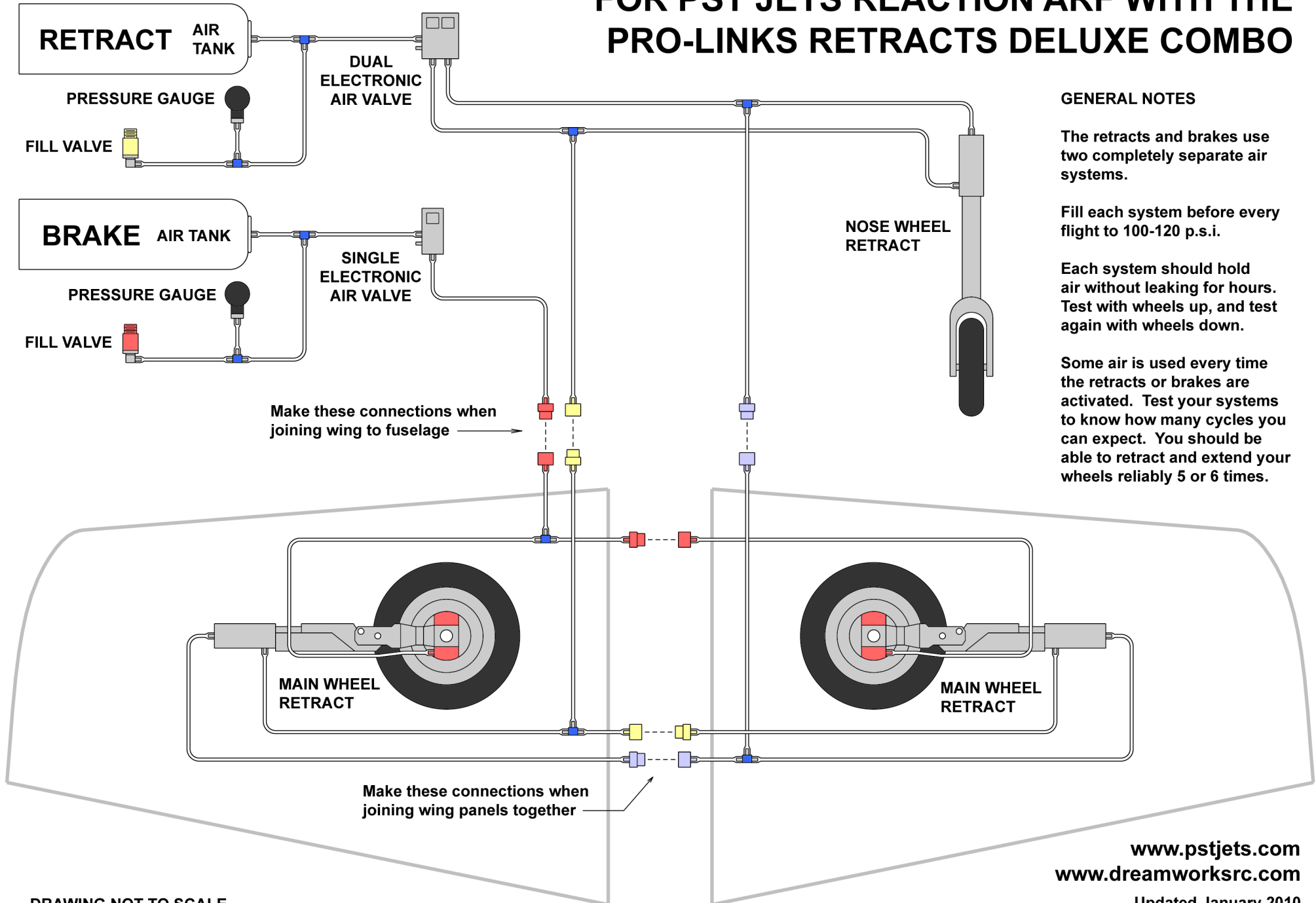

GENERAL NOTES

The retracts and brakes use two completely separate air systems.

Fill each system before every flight to 100-120 p.s.i.

Each system should hold air without leaking for hours. Test with wheels up, and test again with wheels down.

Some air is used every time the retracts or brakes are activated. Test your systems to know how many cycles you can expect. You should be able to retract and extend your wheels reliably 5 or 6 times.